

Steering Pump

Pulley Replacement

1. Drain the fluid from the pump.
2. Hold the steering pump in a vise with soft jaws, and hold the pulley with the special tool, and remove the pulley nut and pulley.

CAUTION: Be careful not to damage the pump housing with the jaws of the vise.

NOTE: Pulley nut has right hand threads.

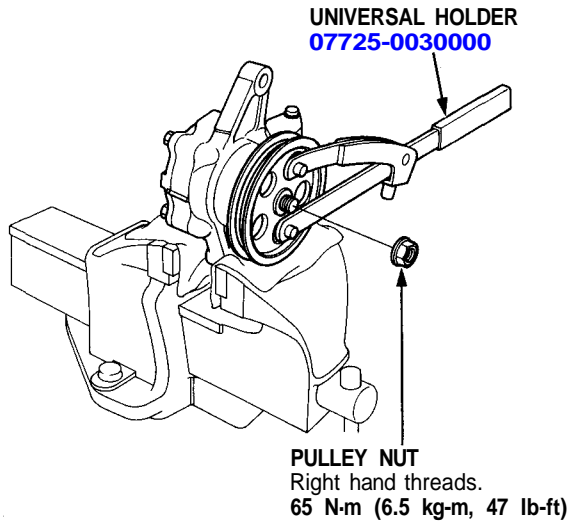

3. Install the pump pulley with its flat surface facing out as shown. Then install the pulley nut.
4. Hold the pulley with the special tool and tighten the pulley nut.

PULLEY NUT
65 N-m (6.5 kg-m, 47 lb-ft)

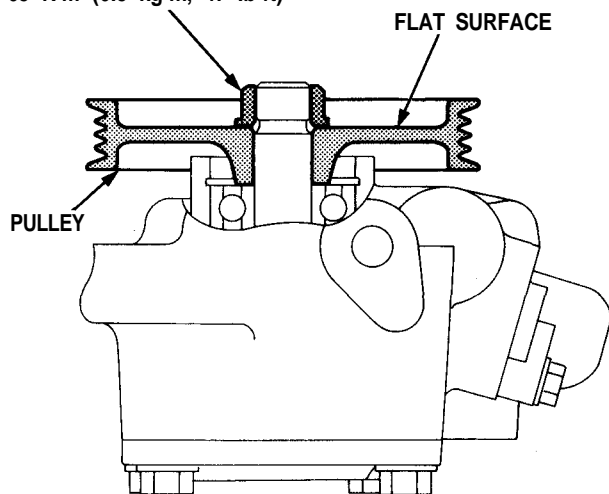

5. Check that the pump turns smoothly by turning the pulley.

Flow Control Valve Inspection and Replacement

CAUTION: The pump components are made of aluminum. Be careful not to damage them when servicing.

1. Remove the valve cap by removing the two flange bolts.
2. Remove the flow control valve, spring and 22.1 x 1.9 mm O-ring.

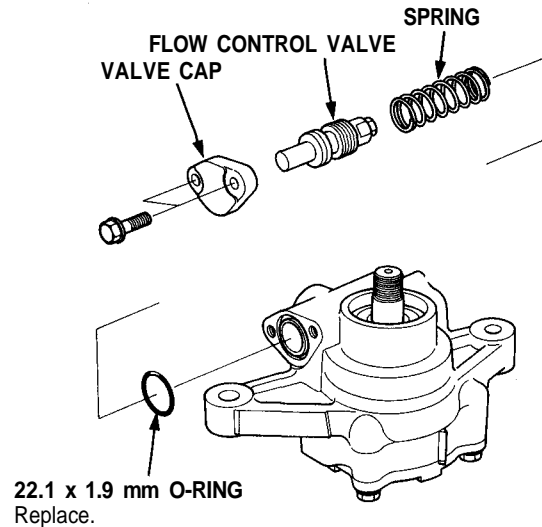

3. Check for wear, burrs, and other damage to the edges of the grooves in the flow control valve.

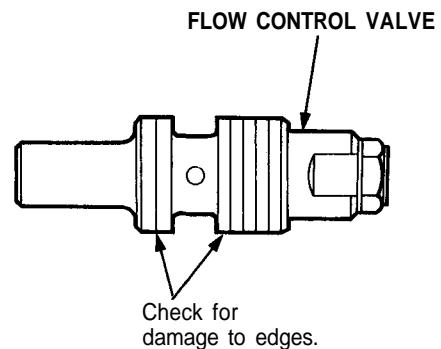



4. Slip the flow control valve back in the pump and check that it moves in and out smoothly.

FLOW CONTROL VALVE

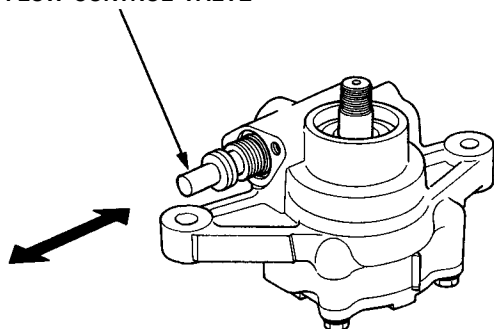

If OK, go on step 5; if not, replace the flow control valve:

NOTE: The original valve was selected for a precise fit in the pump housing bore, so make sure the new one has the same identification mark.

Mark	Part Name	Outside Diameter mm (in)
A	FLOW CONTROL VALVE A	17.991 – 17.995 (0.7083 – 0.7085)
B	FLOW CONTROL VALVE B	17.996 – 18.001 (0.7085 – 0.7087)

5. Attach a hose to the end of the flow control valve as shown.

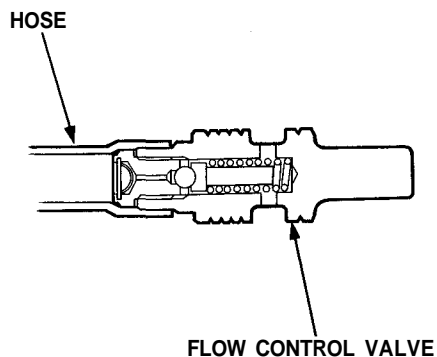

6. Submerge the flow control valve in a container of power steering fluid or solvent, and blow in the hose. If air bubbles leak through the relief valve, replace or repair it as follows.

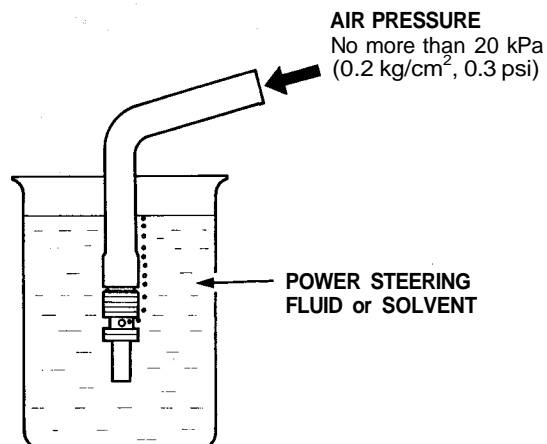

7. Clamp the bottom end of the flow control valve in a vise with soft jaws.
8. Unscrew the seat in the top end of the flow control valve, and remove any shims, the relief check ball, relief valve and relief valve spring.

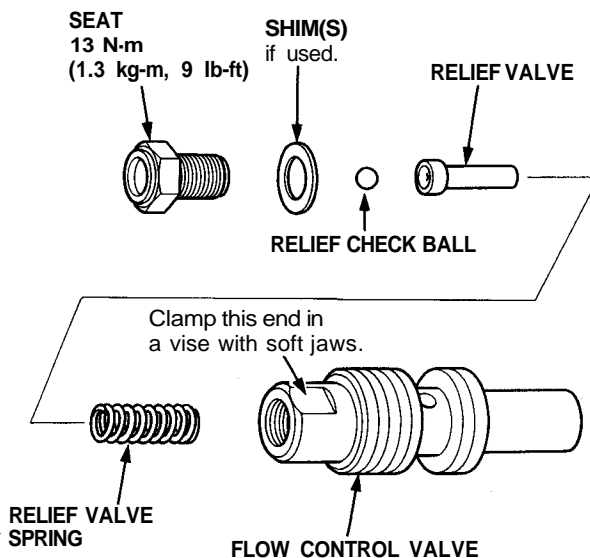

(cont'd)

Steering Pump

Control Valve Inspection and Replacement (cont'd)

9. Clean all the parts in solvent, dry them off then reassemble and retest the flow control valve.

NOTE: If necessary, relief pressure is adjusted at the factory by adding shims under the check ball seat. If you found shims in your valve, be sure you reinstall as many as you took out.

10. Install the flow control valve in the reverse order of removal.

- Apply steering grease (Honda P/N 08733-B070E) to new O-ring.
- Coat the flow control valve with power steering fluid then install it and the spring.

NOTE: When replacing the flow control valve, be sure the replacement flow control valve has the same identification letter as the original flow control valve.

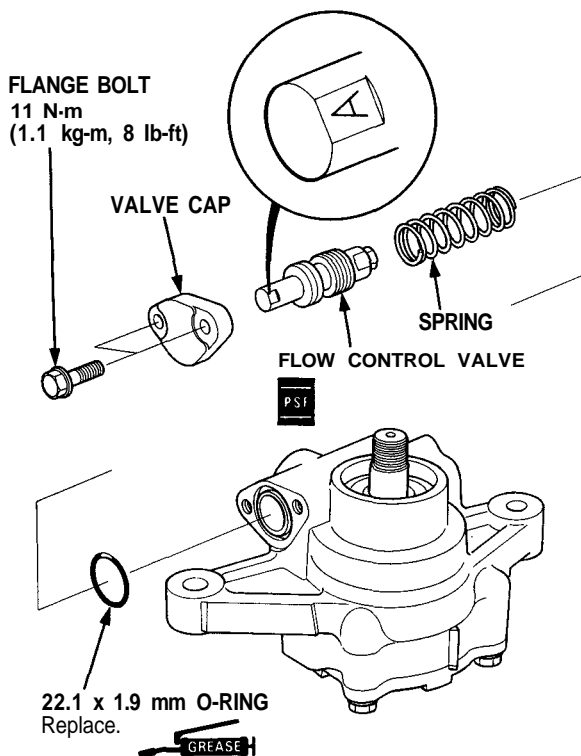

Pump Disassembly

CAUTION: The pump components are made of aluminum. Be careful not to damage them when servicing.

1. Remove the pump from car (see page 17-31).
2. Remove the pulley (see page 17-32).
3. Remove the flow control valve (see page 17-32).
4. Remove the inlet joint and 13.3 x 1.9 mm O-ring.

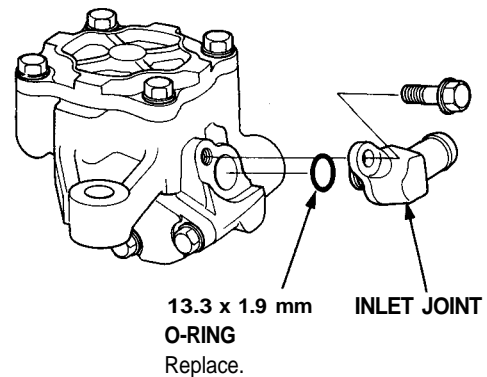

5. Remove the pump cover.

